

FLOODED HIGH TEMPERATURE BATTERY

55068HT (12V49Ah)



CHARACTERISTICS

Item	Specifications
Nominal Voltage	12V
Nominal Capacity (20HR)	49Ah
Reserve Capacity	77min
Cold Cranking Amps@0°F (-18°C)	380A
Dimension	Length
	207mm(8.15inches)
	Width
Height	175mm(6.89inches)
	190mm(7.48inches)
Approx Weight	12.5kg(27.6lbs)
Terminal	1
Cell layout	1
Hold-Down	B13
Case	Black-PP Material
Cover	Black-PP Material
Handle	TS2

APPLICATIONS

- Car start
- EV/HEV
- Engine start

GENERAL FEATURES

- Design for high temperature countries and regions
- Superior life in high temperature environment
- High tin alloy and thicker positive grid
- High-temp paste
- Patented venting system bring less water loss and prevent acid leakage

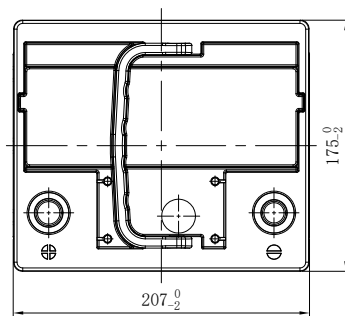
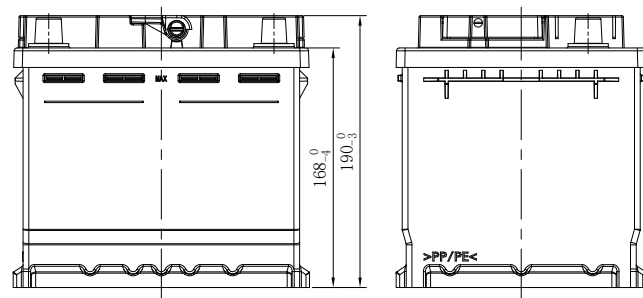
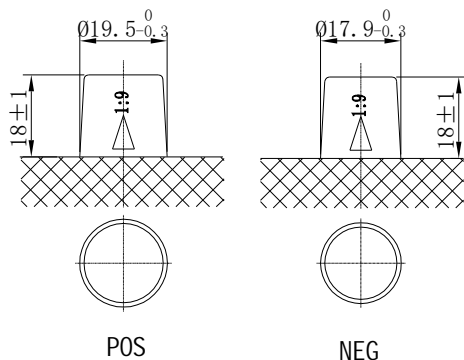

*Values are subject to variation of +/- 5% in normal manufacturing processes.

Leoch International Technology Ltd.

www.leoch.com

Leoch Batteries Pte Ltd

www.leoch.sg

Leoch Battery Corporation

www.leochamericas.com

Leoch Europe S.A.

www.leoch.eu

Data above is recommended and the picture is only for battery effect display, Leoch reserve the final right of explanation.
© LEOCH. All rights reserved.Trademarks and logos are the property of LEOCH and its affiliates unless otherwise noted.Subject to revisions without prior notice. E&OE.

Publication No.:LB-55068HT-PD-EN-V1.0-20250917